

## SBS Details: D1.7.3-1 Edges & Fascia (Cant Edge)

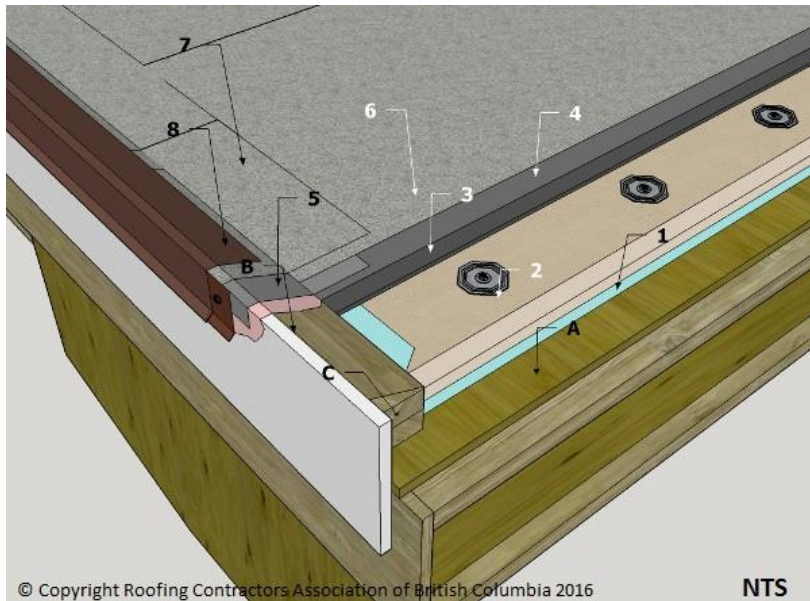
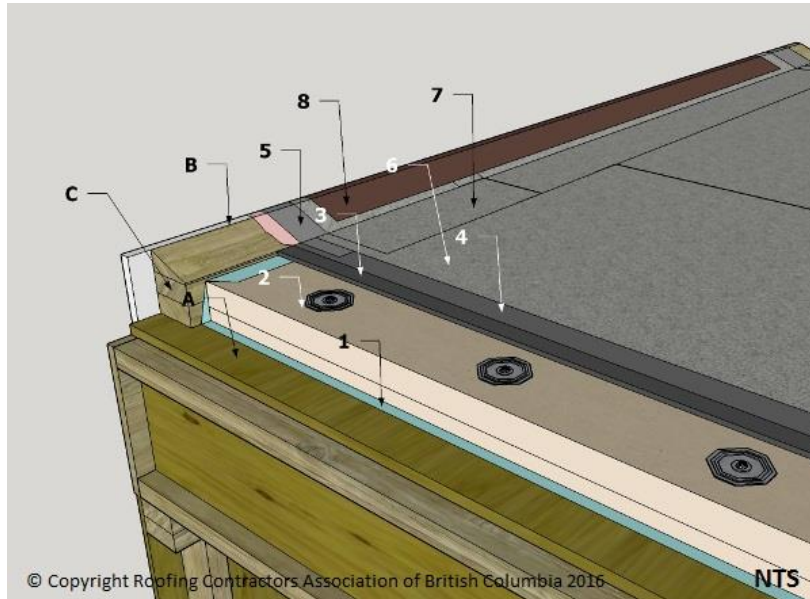

**Notice to reader:** Drawing for illustration purposes only. Consult the RoofStar Guarantee Standards for more information.

### 1 WORK INCLUDED

(1) [Vapour Retarder](#)

If required by design authority.

(2) [Insulation](#)

Mechanically fastened where deck type permits. See available insulation products in the [Accepted Materials](#) section of this Manual.

(3) **Insulation Overlay Board**

Asphalt adhered or mechanically fastened. Two layers required over heat-sensitive insulation.

(4) **Base Sheet**

Adhered to overlay board using asphalt, cold adhesive, self-adhered, mechanical attachment or torch applied according to manufacturer's specification. Torching directly to wood surfaces is not permitted.

(5) **Base Sheet Flashing**

Adhered according to manufacturer's specifications, using cold adhesive, hot asphalt self-adhered or torch applied to cover boards, or mechanically attached membrane. Must be carried over to outside of fascia. Torching directly to wood surfaces is not permitted. See also **10.3.6 Cant Strips**.

(6) **Cap Sheet**

Applied according to manufacturer's printed instructions and *RoofStar Guarantee Standards*.

(7) **Cap Sheet Flashing**

Applied according to manufacturer's printed instructions and *RoofStar Guarantee Standards* up to the top of cant.

(8) **Metal Flashing**

As required by *RoofStar Guarantee Standards*.

---

## 2 RELATED WORK BY OTHERS

(A) **Acceptable Deck**

Smooth, dry and clean.

(B) **Fascia**

Optional.

(C) **Wood Blocking**

Equal to height of insulation and overlay board, primed wherever in contact with asphalt.



ROOFING CONTRACTORS  
ASSOCIATION OF  
BRITISH COLUMBIA



**RoofStar**  
GUARANTEED. BETTER.